

SECTOR - 46C

CHANDIGARH PROJECT

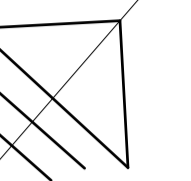

CENTRE LINE OF V-3 ROAD

SCHEDULE OF ACCOMMODATION :-

CATEGORY OF PLOTS	SIZE OF BLOCK	AREA IN SQ.FTS.	NO. OF BLOCK	NO. OF UNITS
(L) L.I.G. FLATS	47'-3"x51'-0" o/o	2409.75	24	288
M.I.G. DUPLEX	22'-6"x46'-6" o/o	1046.25	64	128
TOTAL			88	416

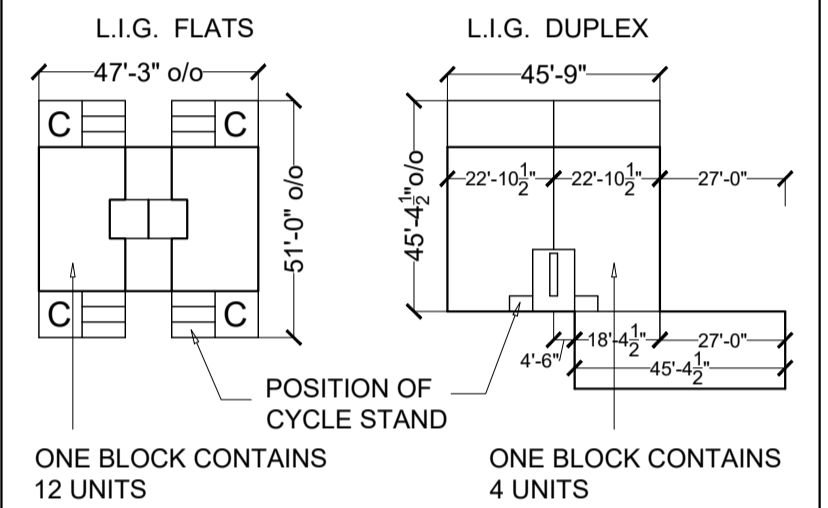

NOTES :-

- FOR HOUSE PLAN L.I.G. FLATS REFER ARCHITECTURAL DRAWING NO. 1 & 2, JOB NO. 32 SUPPLIED BY ARCHITECT C.H.B. VIDE HIS MEMO NO. ARCH. 79/375 DATED 18-07-79.
- FOR STANDARD DESIGN OF L.I.G. DUPLEX REFER ARCHITECTURAL DRG. NO. 2 & 3, JOB NO. 40 SUPPLIED BY ARCHITECT C.H.B.
- FOR L.I.G. FLATS NUMBERING OF HOUSING UNITS OF GROUND FLOOR SHALL BE DISPLAYED AS SHOWN ON THIS PLAN AND THE FIRST & SECOND FLOORS FOR UNITS SHALL BE DISPLAYED AS NUMBER OF GROUND FLOOR / 1 & 2 RESPECTIVELY.
- FOR L.I.G. (DUPLEX) HOUSES, NUMBERING OF HOUSING UNITS OF GROUND FLOOR SHALL BE DISPLAYED AS SHOWN ON THIS PLAN AND THE FIRST & SECOND FLOOR FOR THE ANOTHER UNIT SHALL BE DISPLAYED AS NUMBER OF GROUND FLOOR / 1.

NOTE :-

- HOUSE NUMBERS FROM 3313 TO 3352 HAVE BEEN RE - ARRANGED DUE TO ALLOTMENT MADE AS PER PART NUMBERING PLAN ISSUED, BEARING DRAWING NO. 27, JOB NO. 56 DATED 18-04-80.

Saroj
17-02-83

17-02-83
A.T.P.

CHIEF ARCHITECT

Sd.-

DIVNL. TOWN PLANNER ASST. TOWN PLANNER

SCALE : 40 FEET TO AN INCH

DRAWN : Roopa CHECKED : Saroj

DRG. NO. 30 JOB. NO. 56 DATED : 05-05-1982

NUMBERING PLAN OF SECTOR 47-D FLATS & DUPLEX CHANDIGARH HOUSING BOARD

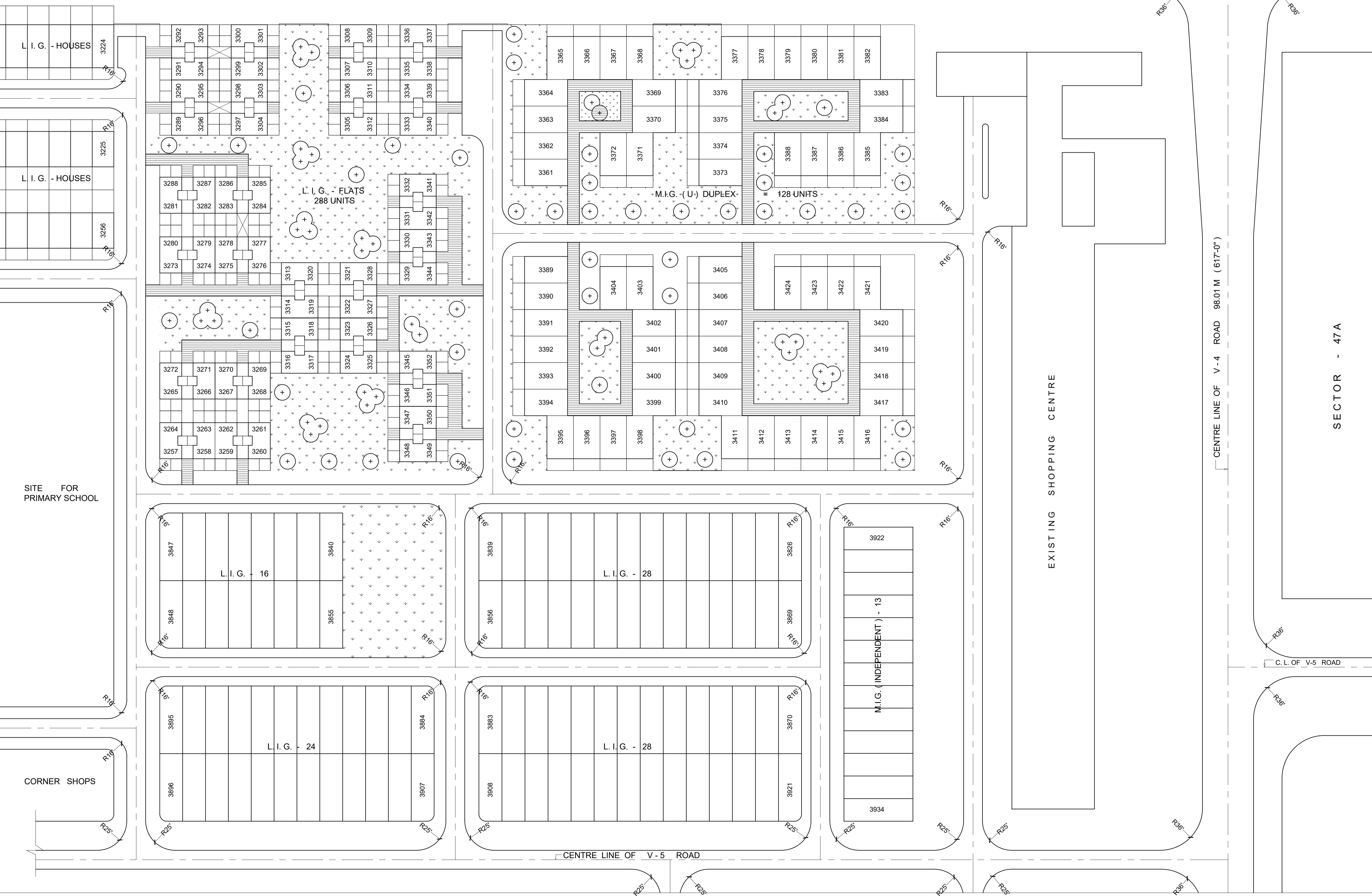

SECTOR - 47A

EXISTING SHOPPING CENTRE

CENTRE LINE OF V-4 ROAD 96.01 M (617'-0")

CENTRE LINE OF V-5 ROAD

SITE FOR PRIMARY SCHOOL

CORNER SHOPS