

# CHANDIGARH HOUSING BOARD

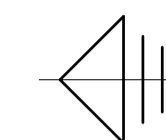

SCHEDULE OF ACCOMMODATION				
CATEGORY	SIZE OF PLOT	AREA OF ONE PLOT	NO. OF PLOTS	NO. OF UNITS
ONE ROOM	12'-0"x18'-0"	216.0 sq.ft.	3285	3285

NOTE :-  
THE CENTRAL UNIT IN THE CLUSTER OF 49 UNITS SHALL BE GIVEN THE SAME NUMBER AS OF THE ADJOINING DWELLING UNIT & SHALL BE APPENDED WITH "A".

NOTE :-  
THE NUMBER OF CENTRAL UNIT IN THE CLUSTER OF 49 UNITS BLOCK HAVE BEEN INCORPORATED IN THE NUMBERING PLAN OF MAULI JAGRAN. NUMBERS RECEIVED VIDE MEMO NO. E.E.-II/W-140/83/1021 DATED 19-03-1993

D.T.P (H.B)

Saraj  
22-03-93

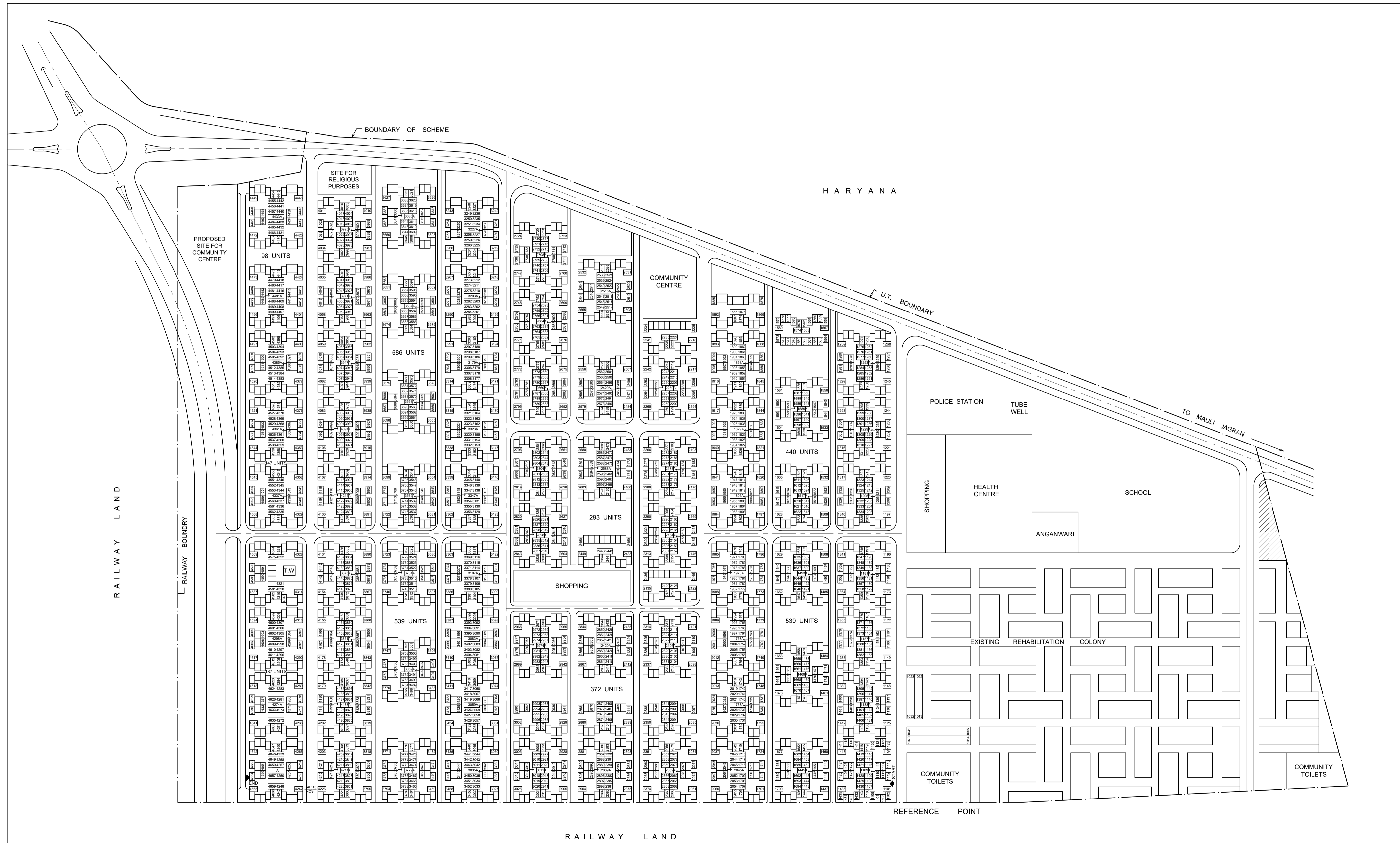

06-11-92	06-11-92
CHIEF ARCHITECT	SENIOR TOWN PLANNER
06-11-92	Sham Sher Singh 06-11-92
SENIOR ARCHITECT	DIV. TOWN PLANNER
SCALE :- EIGHTY FEET TO AN INCH	
DRAWN :- Saraj	CHECKED :-
DRG. NO. 3	JOB. NO. 20
DATE: 06-11-1992	

**NUMBERING PLAN OF RESETTLEMENT COLONY AT MAULI JAGRAN (REVISED)**