

# CHANDIGARH HOUSING BOARD

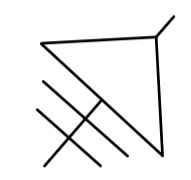

## SCHEDULE OF ACCOMMODATION

CATEGORY OF HOUSES	SIZE OF PLOT	AREA IN SQ. YDS.	NO. OF PLOTS	NO. OF UNITS
CATEGORY II BOARD EMPLOYEE	28'-0" x 70'-0" c/c o/c	217.77	4	12

NOTE :-  
 1. NUMBERING OF DWELLING UNITS ADDED.  
 2. NUMBERING OF HOUSING UNITS OF GROUND FLOOR SHALL BE DISPLAYED, AS SHOWN ON THIS PLAN & NUMBERING OF HOUSING UNITS 1ST & 2ND FLOOR SHALL BE DISPLAYED AS NUMBERS ON G.F. / 1 / 2 RESPECTIVELY.

Sd.-  
 CHIEF ARCHITECT

Sd.-  
 SENIOR TOWN PLANNER

Sunil Manchanda  
 Sd.-  
 SENIOR ARCHITECT

Sham Sher Singh  
 Sd.-  
 04-08-1993  
 DIVISIONAL TOWN PLANNER

SCALE :- EIGHTY FEET TO AN INCH

DRAWN BY :- Ranjit

CHECKED :- Saroj Grover

DRG. NO. 5 | JOB. NO. 15 | DATED:- 04-08-1993

## LAYOUT PLAN OF SPECIAL SCHEME FOR BOARD EMPLOYEES SECTOR 41-D (CATEGORY II)

THIS NUMBERING PLAN HAS BEEN APPROVED BY CHIEF ARCHITECT, U.T. VIDE HIS OFFICE MEMO NO. S.T.P./94 11931 DATED 04-10-94

Sham Sher Singh  
 06-09-94  
 D.T.P., CHB.

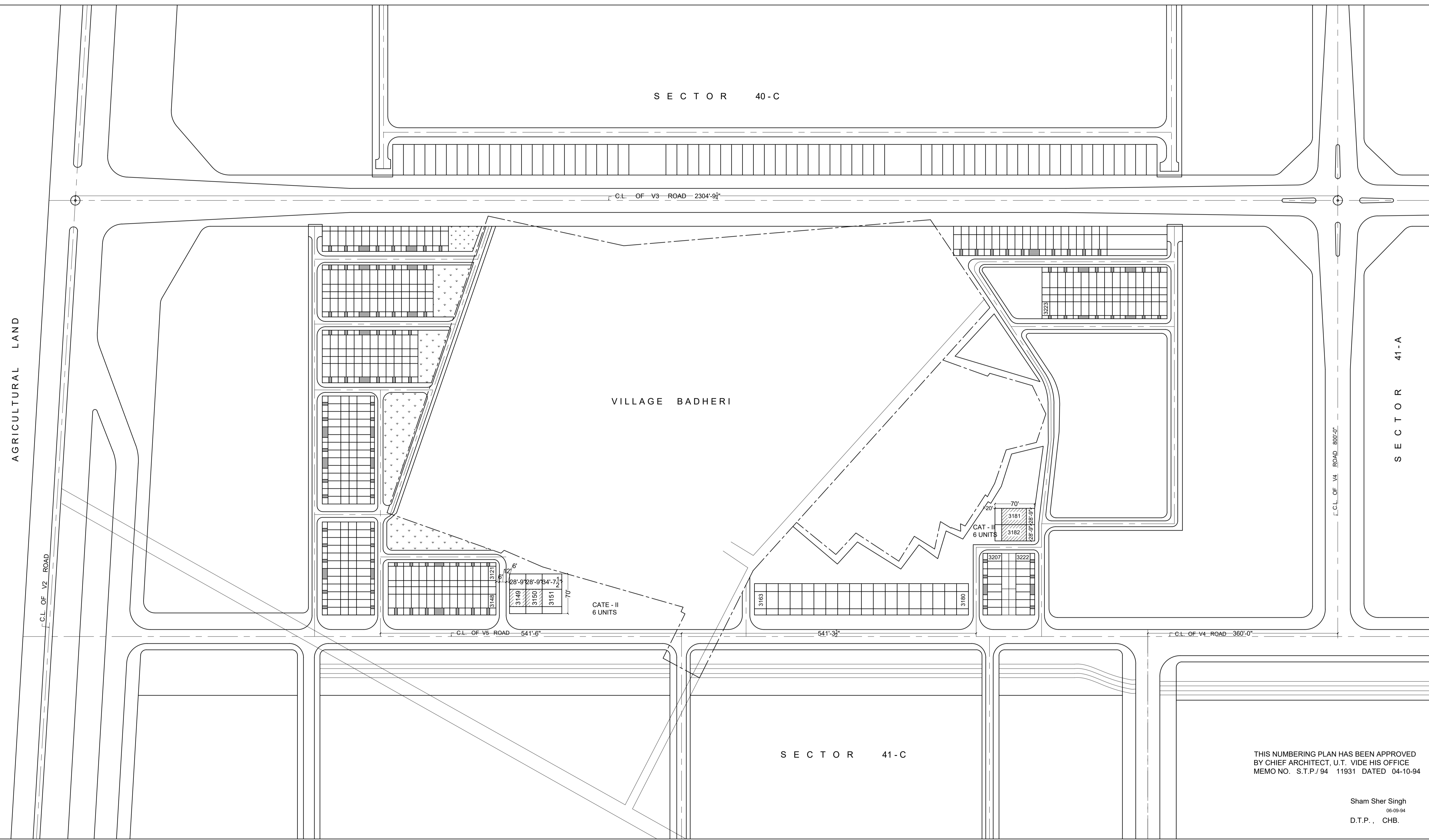

SECTOR 40-C

C.L. OF V3 ROAD 2304'-9 1/2"

VILLAGE BADHERI

CATE - II  
 6 UNITS

CAT - I  
 6 UNITS

SECTOR 41-C

AGRICULTURAL LAND

C.L. OF V2 ROAD

C.L. OF V5 ROAD 541'-6"

541'-3 1/2"

C.L. OF V4 ROAD 360'-0"

C.L. OF V6 ROAD 880'-0"

SECTOR 41-A