

CHANDIGARH PROJECT

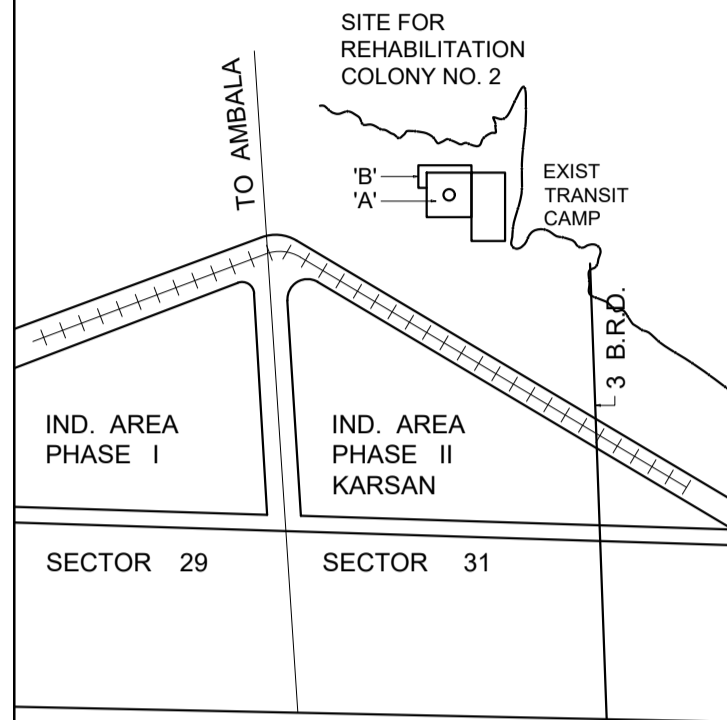
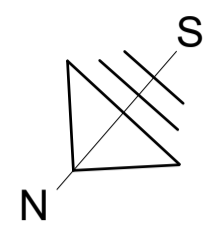

INSET PLAN (NOT TO SCALE)

LEGEND

DISCRPTION	SIZE OF PLOT	TOTAL AREA OF PLOT	TOTAL NOS OF PLOT
RESIDENTIAL	10'-9"x37'-3"	400.4 sq.ft	1046 - A 344 - B
SHOP CUM RESIDENCE	10'-9"x48'-0"	516.0 sq.ft	18
BOOTHES	8'-3"x24'-9"		88
		TOTAL	1496

AREA OF COLONY NO. 2 = 30.02 ACS. = A
 EXTENSION TO COLONY = 7.32 ACS. = B
 TOTAL = 38.34 ACS.

POCKETS RESERVED FOR SERVICE



NOTE:-
 THIS DRAWING SUPERCEDED OF THE PREVIOUS DRG. NO. 82 JOB NO. 5, DATED 22.06.1978
 THE SHOP CUM RESIDENCE NO. 483-500 AND 891-908 HAVE BEEN CONVERTED INTO SHOPPING NO. 106 TO 193 AS DESIRED THE D.C.A

NOTE:-
 THE SITE OF DISPENSARY HAS BEEN INCORPORATED VIDE LETTER NO. ARCH 79/11910 DATED 30.11.79

NOTE:-
 THE SITE OF TUBE WELL TOWARDS THE SOUTH EAST DELETED VIDE THE OFFICE MEMO NO. K-23/ S.T.P.-80/14568 DATED 15/2.80

NOTE:-
 THIS DRAWING IS THE TRACING OF ORIGINAL DRAWINGS BEARING DRG. NOS. 84 & 92 JOB NO. 5 AND TRACED ON 16-07-82

Sd/- CHIEF ARCHITECT
 Sd/- SENIOR TOWN PLANNER

Sd/- DIVISIONAL TOWN PLANNER
 Sd/- ASSTT. TOWN PLANNER

SCALE : 80 FEET TO AN INCH
 DRAWN : Sd/- CHECKED :

DRG. NO. 10 JOB NO. 3

REVISED LAYOUT PLAN OF REHABILITATION COLONY NEAR INDUSTRIAL AREA PHASE - II (KARSAN)

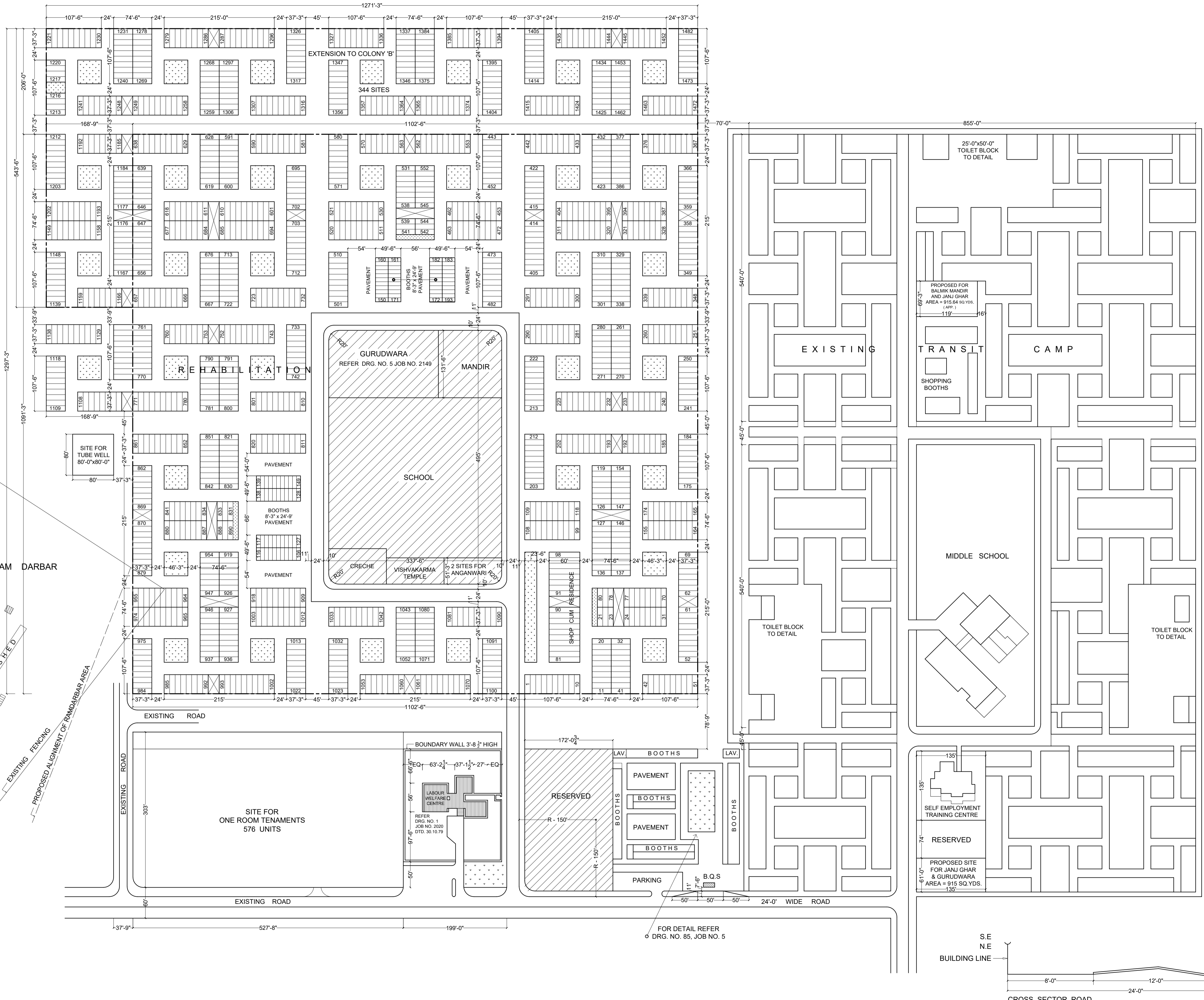

NOTE:-
 THE DEPTH OF SHOP CUM RESIDENCE NO. 81 TO 98 HAS BEEN INCREASED FROM 48'-0" TO 60'-0" AS PER DEMAND MADE IN THE D.O. NO. 9980 DATED 20-11-79 BY THE CHIEF ENGINEER & SECRETARY ENGG. DEPTT. U.T CHANDIGARH.

NOTE:-
 THE SITE OF DISPENSARY HAS BEEN INCORPORATED VIDE LETTER NO. ARCH 79/11910 DATED 30.11.79

NOTE:-
 THE SITE OF TUBE WELL TOWARDS THE SOUTH EAST DELETED VIDE THE OFFICE MEMO NO. K-23/ S.T.P.-80/14568 DATED 15/2.80

NOTE:-
 THIS DRAWING IS THE TRACING OF ORIGINAL DRAWINGS BEARING DRG. NOS. 84 & 92 JOB NO. 5 AND TRACED ON 16-07-82

REPRODUCED
 Sd/- 04.12.79 A.T.P.
 Sd/- 10.12.79 A.T.P.
 Sd/- 17.12.80 A.T.P.
 Sd/- 19.07.82 CHECKED BY-

